

## LED Wall Light

Type : LED Wall Light 13W AC220V IP65 CREE LED (Up & Down)

Model No : B-003504

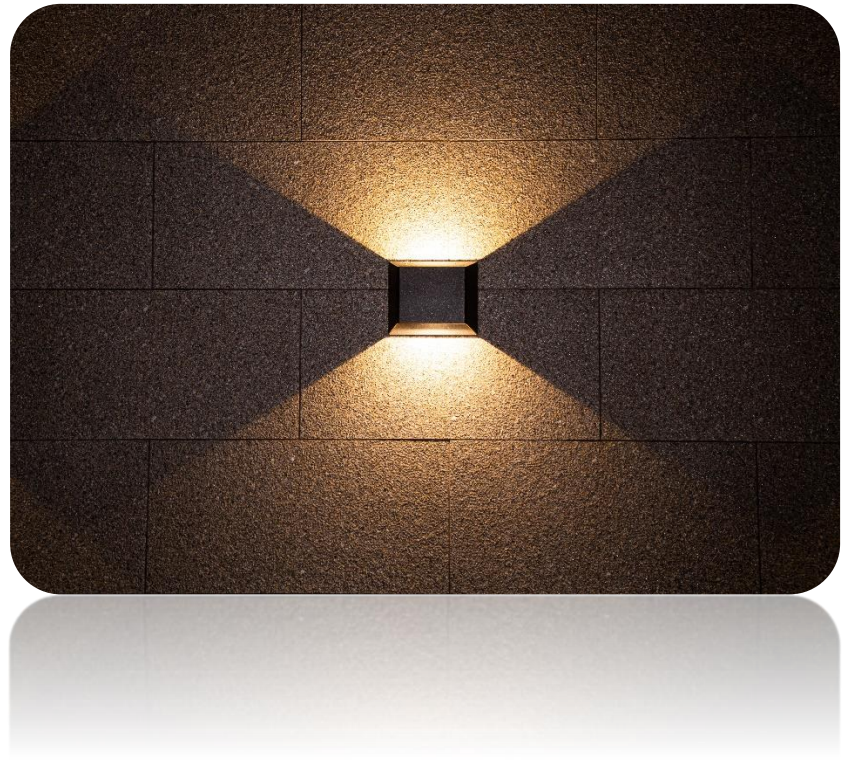

### ■ Features

- **Low Power Consumption:** LED technology uses much less energy than incandescent or halogen lights, making LED Wall/ Lawn energy-efficient and cost-effective in the long run.
- **Long Lifespan:** LEDs can last up to 50,000 hours or more, significantly reducing the need for replacements compared to traditional bulbs
- **Uniform Lighting:** LED Wall/ Lawn lights provide even, glare-free illumination, which is ideal for walls, gardens, or around buildings without creating harsh shadows
- **Accent Lighting:** Used to highlight architectural features, landscape elements (like plants or statues), or pathways.
- **Enhanced Security:** Properly placed Wall/ Lawn lights can discourage trespassing or crime in poorly lit areas by providing consistent illumination.
- **Low Carbon Footprint:** LED lights emit less CO2 compared to traditional lighting options.
- **No Harmful Chemicals:** LEDs do not contain mercury or other harmful substances, unlike certain other types of lighting such as CFLs.
- **Minimal Upkeep:** Due to the long lifespan and rugged design, LED Wall/ Lawn lights require very little maintenance, saving both time and money on replacements and repairs.
- **No Filament or Bulb Replacement:** Since LEDs don't use filaments, they are less prone to breakage compared to traditional light sources
- **No UV Radiation:** Unlike some traditional light sources, LEDs emit negligible ultraviolet (UV) radiation, which makes them safe for the environment and surrounding plant life
- **Easy Installation :** LED Wall/ Lawn lights are generally easier and faster to install than traditional lighting, especially if the Wall/ Lawn is designed for surface mounting, reducing labor costs and downtime.

## ■ Specification

Part Number	B2834-13UDF
Power	13W
Voltage	AC 220V
LED	<b>CREE</b>  LEDs
LED Color	Warm White
Luminous Efficacy	47 LM/W
Lumens	599 LM
Light Projection	Up & Down
Body Material	Die Casting Aluminium & Tempered Glass Diffuser
Body Color	Black
Surface Finish	Polyester Powder Coating
IP Grade	IP 65
Impact Strength (IK)	IK06
UV - Resistant	F1
Frequency	50/ 60Hz
Beam Angle	86°
Color Rendering Index	≥ 80
Life Span	50,000 Hours
Safety	Class 1
Net Weight	0.82 KG
Dimensions (mm)	180x150x73
Working Temperature	-30°C ~ +45°C

## ■ Dimensions

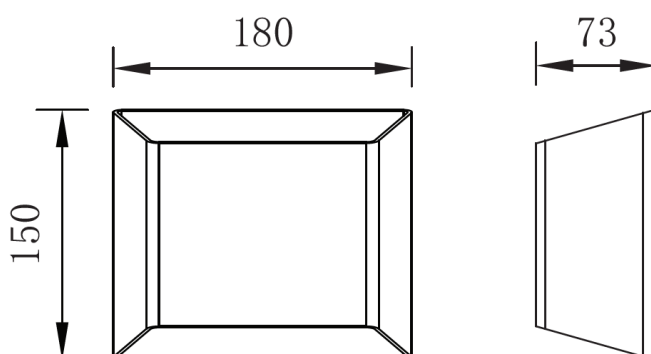

## ■ Light Distribution Curve

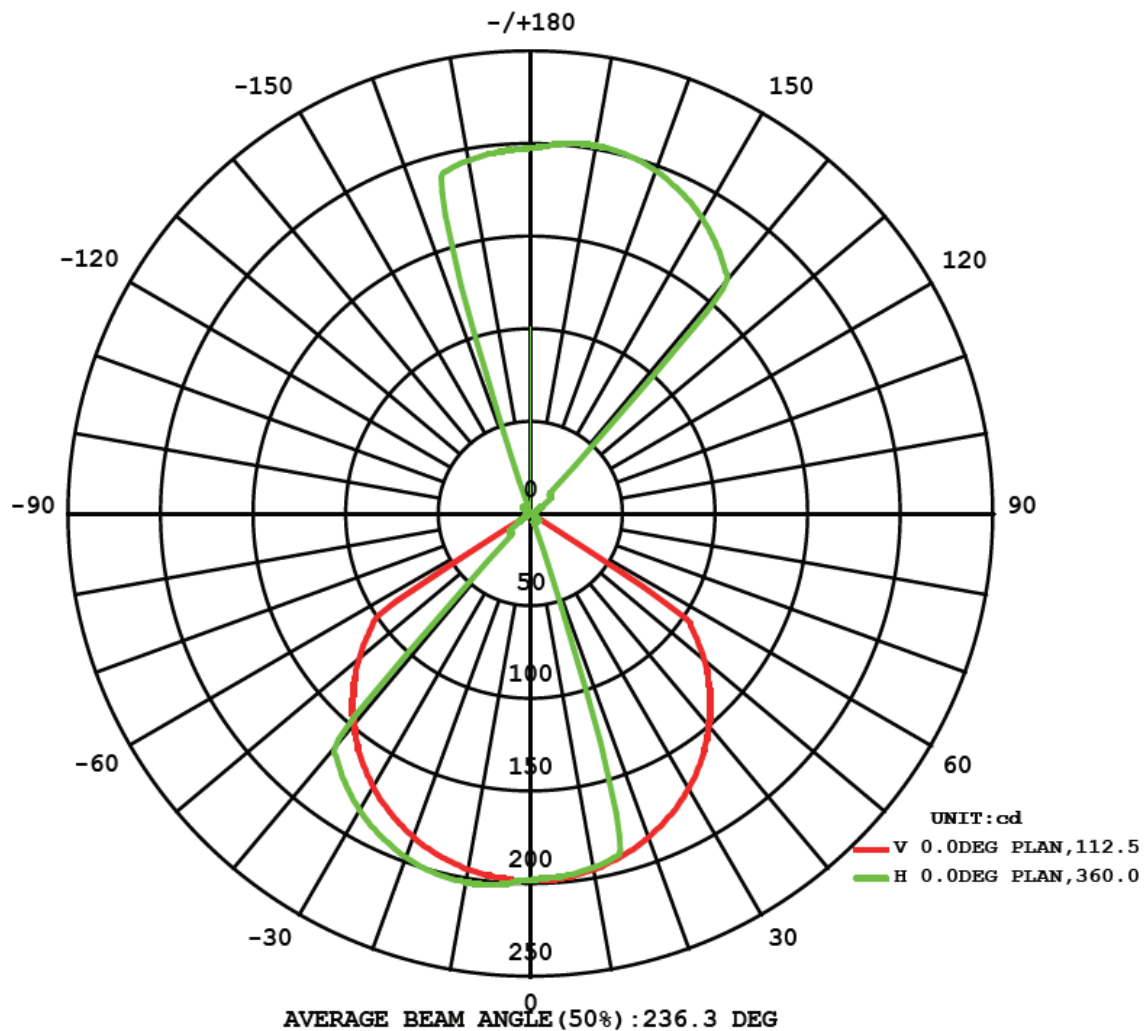

## ■ Applications

- **Home Lighting** – Accent Lighting, Ambient Lighting
- **Outdoor & Landscape Lighting** – Exterior Wall Lighting, Garden & Patio Lighting, Security Lighting
- **Commercial Spaces** – Office, Retail Stores, Hotel & Restaurant Lighting
- **Architectural and Interior Design** - Wall Washing & Grazing, Feature Walls, Backlighting for Mirrors or Art
- **Hospitality & Entertainment Venues** - Theater & Performance Spaces, Bars & Clubs, Event Venues
- **Healthcare and Wellness Spaces** - Hospitals & Clinics, Spas & Wellness Centers
- **Public Spaces** - Museum & Gallery Lighting, Libraries & Educational Institutions, Transportation Hubs
- **Accent and Decorative Lighting** - Seasonal or Festive Lighting, Mood Lighting









[www.brightledlight.co.uk](http://www.brightledlight.co.uk)

**Model No : B-003504**  
**Part No : B2834-13UDF**

## Mounting Instruction

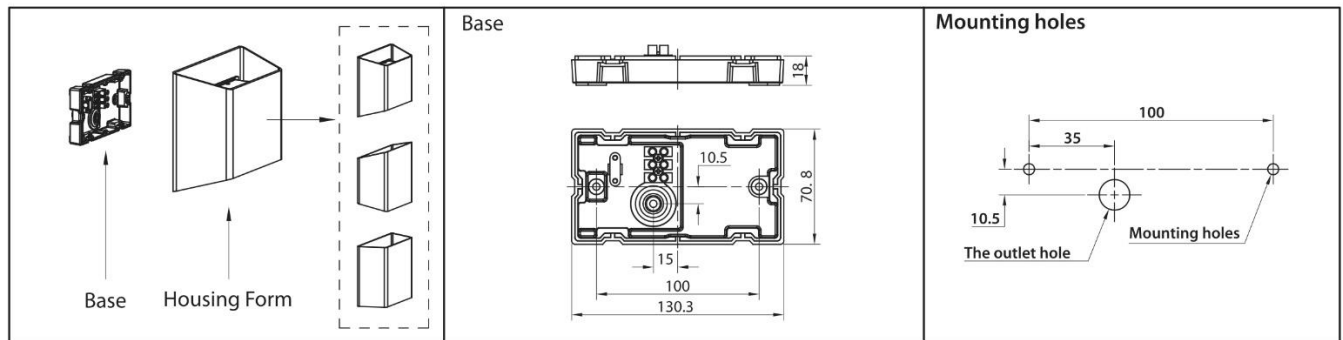
### ■ Components and Tools



### ■ Installation Steps

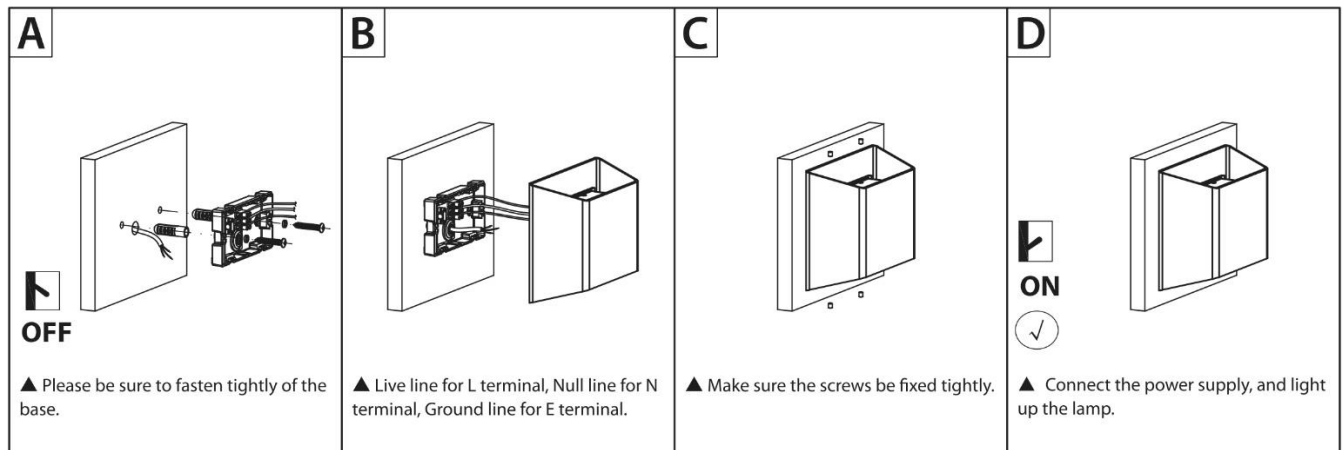

### ■ Notes:

1. Read this manual of instructions carefully before installation and keep it for future reference;
2. The lamps should be installed or repaired by professional electricians;
3. Please place the waterproof rubber correctly, otherwise it will be invalid for our guarantee;
4. The light source of this lamp should be replaced by the manufacturer or its service agent or a similarly qualified person;
5. If the external flexible cord of this lamp is damaged, for the sake of avoiding hazard the cord should be replaced by the manufacturer or its service agent or a similarly qualified person;
6. Check the power switch has been turned off before install or repair the lamp.