

LED Strip Light

Type :Bright COB LED Strip Light 24V Non Waterproof – 8MM PCB

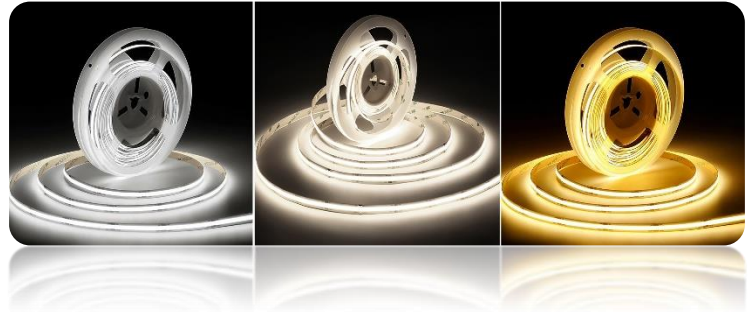

512 LEDs/M	5 Meters	DC 24V	IP 20
----------------------	--------------------	-------------------------	------------------------



Features

- Can be cut at the printed marks
- Highly Reliable
- One BIN only, Good Color Uniformity
- Anti-Oxidation by Silver for Bonding Pad
- Silver-Tin Pad Design, Easy Soldering
- Simple and Elegant
- Life Span : ≤ 50,000hours

Optical and Electrical Parameters

Part No/ Model No	LED Color	Color Temp	CRI	Beam Angle	Luminous Flux	Luminous Efficacy	Working Voltage	Working Current	Power (W)	
		(K)		(°)	(lm/m)	(lm/w)	(V)	(mA/m)	1m	5m
B11512-C512	Pure White	5000-5500	≥80	115°	1080	90	24	1000	12	60
	Neutral White	4000-4500	≥80	115°	1080	90	24	1000	12	60
	Warm White	2700-3000	≥80	115°	1080	90	24	1000	12	60

Others

Part No/ Model No	IP Grade	Operating Temp		Storage Temp		Standard Length		Max. cascading Length		LED Qty
		(°C)	(°F)	(°C)	(°F)	(m)	(inch)	(m)	(inch)	(Pcs/m)
B11512-C512	IP 20	-25~+60	-13~+140	-25~+70	-13~+158	5	196.85	5	196.85	512



■ Applications

- Suitable for Light Boxes, cover and contour lighting etc, in KTV, hotels, shopping malls, home, offices, Cabinets, Kitchens and so on

■ Connection Instruction

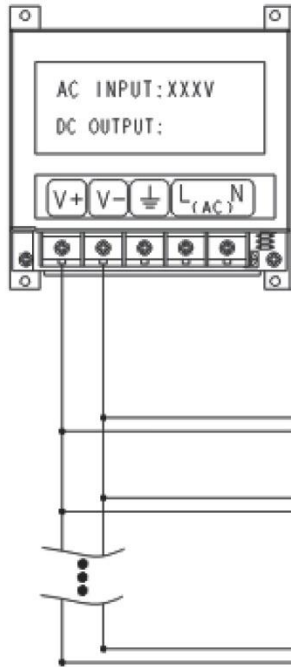

Notes: please make sure the "+" and "-" of the product's input are correctly connected to those of the power supply output.

"+" red wire "-" black wire

■ Trouble Shooting

Malfunctions	Possible Causes	Solutions
All LEDs don't work	1. The power supply did not connect to power grid.	Power on
	2. No electricity due to short-circuit of external power supply.	Remove the malfunction caused by short-circuit, power on again.
	3. The wires of strip light connect to power supply output reversely.	Check the connecting and ensure the wires are connected correctly.
Part of LEDs don't work	1. Part of power supplies do not have output.	Check the power supply system.
	2. Part of wires of strip light have malfunction.	
	3. Particular strip light connected reversely.	Correct connection
Brightness of LEDs is weak or uneven	1. Overloaded power supply;	Replace it with higher power supply
	2. The power loss of power circuit is huge or the power loss of each circuit existing big difference.	Ensure working voltage of strips is within $\pm 5\%$ V of rated voltage. 1. Shorten the length of wires between the first strip and power supply or replaced with wires with bigger diameter; 2. Ensure the cascading qty of string is less than or equal to the allowed maximum cascading qty, and each strip cascading qty is well-balanced.
	3. Exceed in qty of strip light in series	Lessen the cascading qty for strip and ensure the qty for each electrical circuit is within the maximum cascading qty.

Installation Steps & Cautions

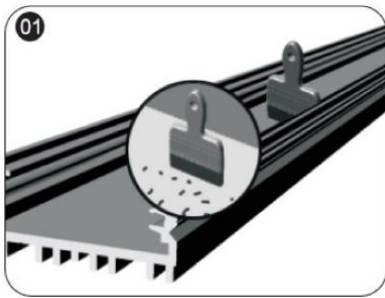

01 Make sure the mounting surface is clean before installation;

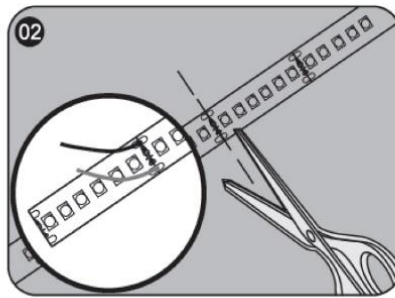

02 Calculate the needed length and cut off the extra length along cutting mark if necessary; if need to add wires, please weld them at the next location with printed mark.

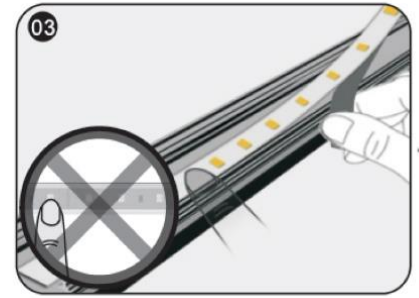

03 while sticking strips, peel off the release paper of the tape step by step. Don't peel off all release paper at a time to avoid getting your strip in a mess.



04 Stick Mylar tape to isolate the cutting position from the bottom of profile inner slot to avoid short-circuit;

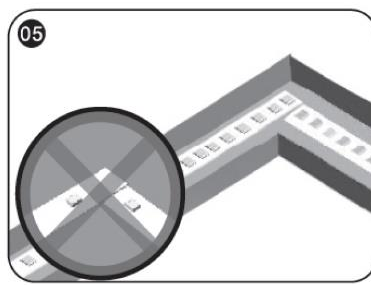

05 The installation at the corner is shown as the above figure.
 △ Notes: No bending it into right angle; No twisting it to stick on the mounting surface.



06 Connect strip wires to the output terminal of power supply, and dispose with waterproof, insulation, short-circuit and anti-corrosion protection at both the wire joints and the cut section of your strip (if any).

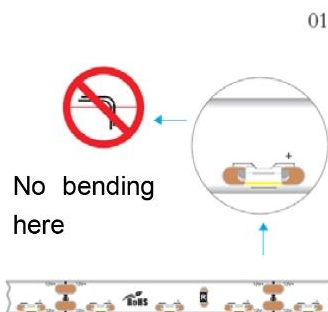

01 No bend the strip at the position of LED

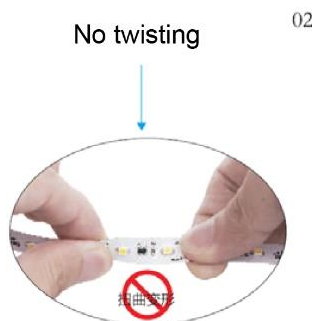

02 No twisting the strip

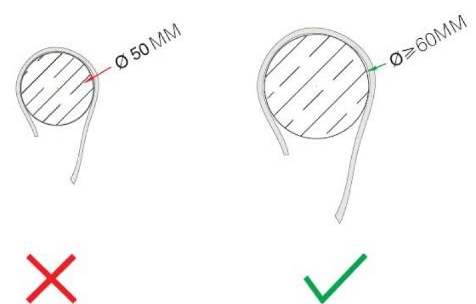

03 No winding an object with a diameter < 5cm.